

## ENSEMBLE DE QUINCAILLERIE POUR RESSORT À GLISSIÈRE 2" 2" SLIPPER SPRING HARDWARE KIT

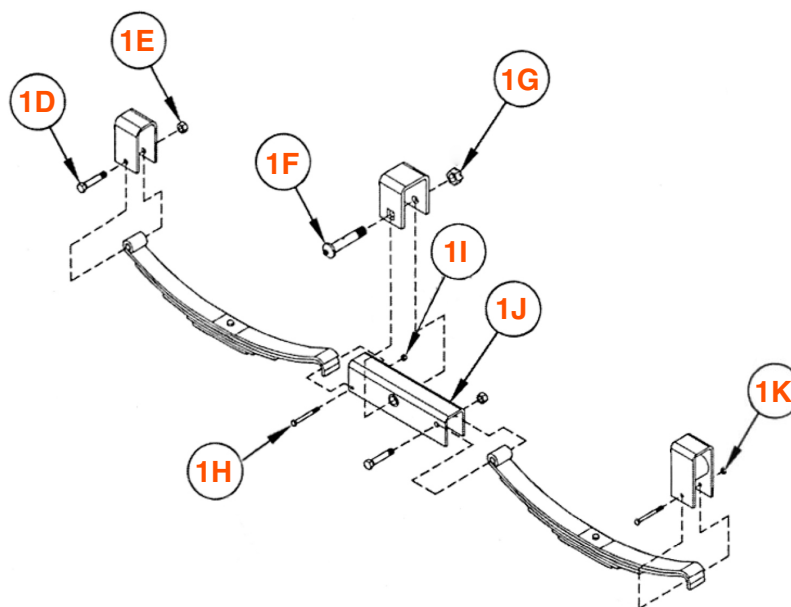

| TYPE DE QUINCAILLERIE<br>HARDWARE TYPE |  | CAPACITÉ<br>CAPACITY | RESSORT*<br>SPRING* |  |
|--|--|----------------------|---------------------|--|
| INDUSTRIELLE / INDUSTRIAL<br>DOUBLE    |  | 8K                   | 2"                  |  |
| COMPOSANTE<br>COMPONENT                | DESCRIPTION  | QTÉ<br>QTY           | PRODUIT<br>PRODUCT  |  |
| 1D                                     | BOULON 9/16"-18 X 3 1/2" NF ZINC BOLT  | 6                    | 60116Z              |  |
| 1E                                     | ÉCROU 9/16"-18 LOCKNUT   | 6                    | 35118L              |  |
| 1F                                     | BOULON 7/8"-9 ZINC (STABILISATEUR INDUSTRIEL) / ZINC BOLT 7/8"-9 (EQUALIZER SLIPPER)   | 2                    | 60126Z              |  |
| 1G                                     | ÉCROU 7/8"-9 ZINC (STABILISATEUR INDUSTRIEL) / ZINC LOCKNUT 7/8"-9 (EQUALIZER SLIPPER) | 2                    | 60127Z              |  |
| 1H                                     | BOULON 3/8"-16 X 3 1/2" NC BOLT  | 2                    | 20136               |  |
| 1I                                     | ÉCROU 3/8"-16 NC NYLON NUT   | 2                    | 20133               |  |
| 1J                                     | STABILISATEUR INDUSTRIEL 8K 13" ZINC EQUALIZER   | 2                    | 80125Z              |  |
| 1K                                     | GOUPILLE 1/8" X 1 3/4" COTTER PIN  | 2                    | 1151C               |  |

\* RESSORT NON INCLUS / SPRING NOT INCLUDED